



FIG EARTH SUPPLY

Events

at FIG EARTH

3577 N Figueroa Street, LA, CA 90065





WELCOME TO OUR OASIS

**We're an events
space inspired by
plants, food, and our
community.**

**Celebrate your special
event under the stars and
among the flora in our urban garden
nursery. Our space transforms into an enchanting
and intimate setting to host you and your guests.**

**Whether its a wedding, shower, photoshoot,
corporate meeting or community gathering,
Events at Fig Earth offers a sustainable and cost-
effective venue to host your next event.**







WHAT YOU GET

We want you to walk away with that feeling of “aahhh...that was easy.” And part of creating that feeling is offering lots of great things in our rental price.

Farm tables, bench seating, and assorted garden furniture for up to 125 guests

Use of our in-house Bose audio surround system and projector

An on-site venue coordinator to answer questions and ensure that everything runs smoothly for the duration of your event

Personalized floor plan laid out by the Fig Earth Supply team

String lighting and custom chandeliers

One bathroom with art mural

Affordability in a Beautiful Setting

Our venue is always changing. Whether its the constantly rotating array of plants and trees, or the selection of artists' pottery displayed on the shelves, each event is unique to the time and place that it is.

PRICING

Fig Earth Events Pricing Tiers	
Up to 50 guests	\$3,000
51-75 guests	\$4,000
76-125 guests	\$5,000

When setting a price for your event, we take into consideration a number of factors including, time of day, day of week, and duration of event to compile a custom quote for your celebration.



Before Anything, we are a Nursery for our Community

*We do not accept events Friday through Sunday in March and April.

*Select weekends have restrictions on day-time rentals.

*We offer discounts to 501 c3's and local organizations doing kick-ass stuff

SHOWERS, WORKSHOPS, WEDDINGS, CONCERTS

You can have it all with Events at Fig Earth



FLOORPLAN

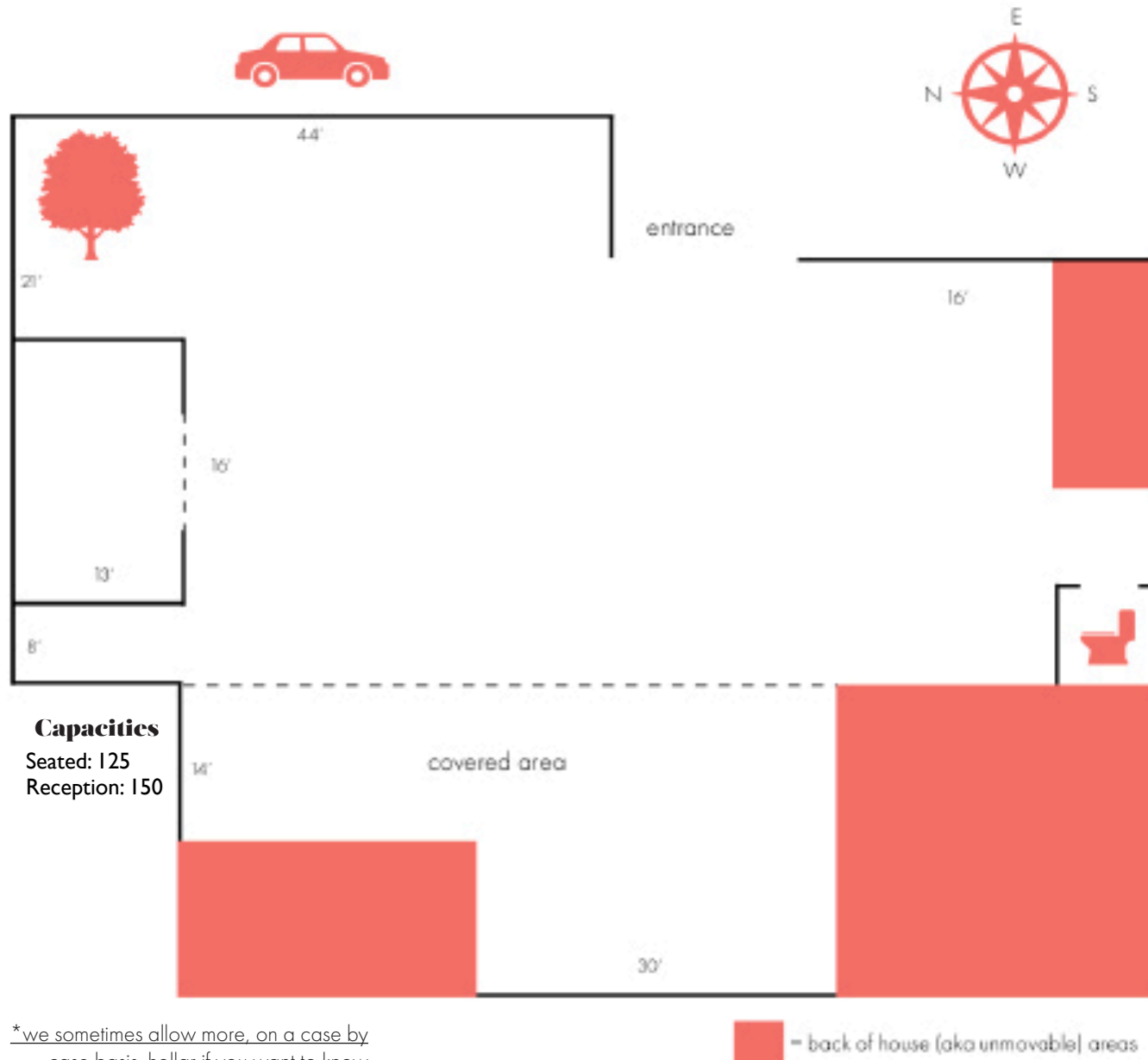

*we sometimes allow more, on a case by case basis. hollar if you want to know

LITTLE DETAILS

Special Event Insurance

We require all events, big and small, to acquire special event insurance for the day(s) of the event. We are more than happy to help you with this process.

Extra Special Handling

Are you having a 10-course meal with fresh livestock that need to be cared for on premise for the week of your event? Possibly a helicopter landing arrival? Or maybe you just need extra time for rental deliveries. Whatever your extra needs are, we can accommodate. Additional rates will apply and are done so on a case-by-case basis.

Music

We allow music of all kinds. Drums, Trombones, Harmonicas, children's choirs and beyond are all permitted. Loud music and all live music must end by 10:30 pm.

Food and Beverage

We have an open catering policy. This means you may bring in whatever or whoever to provide food and libations for your event. We ask for a list of your vendors at the final walk through so we have account of who is entering our property.

Bathrooms

Rental of Additional Bathrooms is required for events over 100 attendees.

Security

Events in the evening may require security personnel. If venue manager deems that your event should require a security guard, he or she will be billed at \$50/hour.

Greening your Event

We strive to make every event at Fig Earth as zero-waste as possible. A designated person will be on-site during the entirety of your event to supervise the proper disposal of trash, recycling, and compost. An additional fee based off of your event length and size will be applied.

Security Deposit

A refundable security deposit of \$500 will be held by our management for up to 1 week after your event. This deposit may held for costs incurred during your event which could include damage to the facility and/or furniture, inventory, or equipment, overtime hours incurred by staff, left over rental equipment; and unforeseen city department fees.

Parking

We have 2 designated parking spots for guest and vendors on-site. Unpermitted parking is available on the street. We may require valet or shared ride vouchers for events exceeding 75 attendees.



BOOK NOW

www.fgearthsupply.com

CONTACT

Alex Dorcean

events@fgearthsupply.com

[@eventsatfgearth](#)

